

# Machine Rod



FINISH: Mill

STOCK CODE	DESCRIPTION D	ALLOY TEMPER	LENGTH METRE	WEIGHT KG/M	STATE		
					V	N	Q
MS6	6	2011 T3	3.6	0.08	●	●	●
MS8	8	2011 T3	3.6	0.14	●	●	●
MS10	10	2011 T3	3.6	0.22	●	●	●
MS12	12	2011 T3	3.6	0.32	●	●	●
MS12.7	12.76	2011 T3	3.6	0.36	●	●	●
MS14	14	2011 T3	3.6	0.43	●	●	●
MS16	16	2011 T3	3.6	0.57	●	●	●
MS19.05	19.05	2011 T3	3.6	0.8	●	●	●
MS20	20	2011 T3	3.6	0.89	●	●	●
MS22	22	2011 T3	3.6	1.07	●	●	●
MS24	24	2011 T3	3.6	1.28	●	●	●
MS25.4	25.4	2011 T3	3.6	1.43	●	●	●
MS27	27	2011 T3	3.6	1.62	●	●	●
MS30	30	2011 T3	3.6	1.99	●	●	●
MS31.75	31.75	2011 T3	3.6	2.23	●	●	●
MS33	33	2011 T3	3.6	2.41	●	●	●
MS36	36	2011 T3	3.6	2.87	●	●	●
MS38.1	38.1	2011 T3	3.6	3.22	●	●	●
MS39	39	2011 T6	3.6	3.37	●	●	●
MS42	42	2011 T6	3.6	3.91	●	●	●
MS45	45	2011 T6	3.6	4.5	●	●	●
MS50	50	2011 T6	3.6	5.54	●	●	●
MS55	55	2011 T6	3.6	6.7	●	●	●
MS60	60	2011 T6	3.6	7.98	●	●	●
MS65	65	2011 T6	3.6	9.36	●	●	●
MS70	70	2011 T6	3.6	10.85	●	●	●
MS75	75	2011 T6	3.6	12.46	●	●	●
MS80	80	2011 T6	1.5	14.18	●	●	●
MS90	90	2011 T6	1.5	17.94	●	●	●
MS100	100	2011 T6	1.5	22.15	●	●	●
MS110	110	2011 T6	1.5	26.8	●	●	●
MS120	120	2011 T6	1.5	31.89	●	●	●
MS130	130	2011 T6	1.5	37.43	●	●	●
MS140	140	2011 T6	1.5	43.41	●	●	●
MS150	150	2011 T6	1.5	50.02	●	●	●
MS160	160	2011 T6	1.5	56.7	●	●	●
MS180	180	2011 T6	Random	72.05		●	●
MS210	210	2011 T6	Random	97.69	●	●	●
MS230	230	2011 T6	Random	119			●
MS250	250	2011 T6	Random	138.98			●
MS254	254	2011 T6	Random	141.88	●		

Other sizes and variations may be available – contact your nearest branch for assistance.



# Round Rod

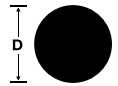

FINISH: Mill

STOCK CODE	DESCRIPTION D	ALLOY TEMPER	LENGTH METRE	WEIGHT KG/M	ANOD PER	STATE		
						V	N	Q
RS6	6	6060 T5	4	0.08	100	●		●
RS10	10	6060 T5	4	0.21	100	●	●	●
RS12	12	6060 T5	4	0.31	100	●	●	●
RSS15.88	15.88	6061 T6	4	0.537	100			●
RS16	16	6060 T5	4	0.54	100	●	●	●
RSS19.05	19.05	6061 T6	4	0.78	100	●		
RS20	20	6060 T5	4	0.86	100	●	●	●
RSS20	20	6061 T6	4	0.86	100	●		●
RSS22.23	22.23	6061 T6	4	1.048	100			●
RS25	25	6060 T5	4	1.33	100	●		●
RSS25.4	25.4	6061 T6	4	1.33	100	●	●	
RSS30.16	30.16	6061 T6	4	1.94	100	●	●	●
RSS31.75	31.75	6061 T6	4	2.15	100	●	●	●
RSS33	33	6061 T6	4	2.318	108		●	●
RSS36.5	36.5	6061 T6	4	2.84	114		●	●
RSS39	39	6061 T6	4	3.23	122	●	●	●
RSS42	42	6061 T6	4	3.755	130	●	●	
RSS44.45	44.45	6061 T6	4	4.19	140	●	●	●
RSS45	45	6061 T6	4	4.5	140	●		●
RSS50.8	50.8	6061 T6	4	5.47	159	●	●	●
RSS51.3	51.3	6061 T6	4	5.601	1.62	●		
RSS55	55	6061 T6	4	6.43	172	●	●	
RSS60.33	60.33	6061 T6	4	7.72	189	●	●	●
RSS65	65	6061 T6	4	9.02	204	●	●	●
RSS70	70	6061 T6	4	10.5	220	●	●	
RSS76.2	76.2	6061 T6	2	12.31	239	●	●	●
RSS82/RSS83	82.55/83	6061 T6	2	14.52/14.66	260	●	●	●
RSS88.9/RSS90	88.9/90.8	6061 T6	2	16.76/17.28	280	●	●	●
RSS101.6	101.6	6061 T6	2	21.89	319	●	●	●
RSS110	110	6061 T6	2	25.78	359	●	●	
RSS114.3	114.3	6061 T6	2	27.83	359			●
RSS120	120	6061 T6	2	31.89	359	●	●	●
RSS130	130	6061 T6	2	35.84	402	●	●	●
RSS139.7	139.7	6061 T6	1.5	41.39	410	●	●	●
RSS140	140	6061 T6	1.5	41.57	410	●	●	●
RSS152.4	152.4	6061 T6	2	49.44	419	●	●	●
RSS160	160	6061 T6	2	54.633	208	●	●	●
RSS177.8	177.8	6061 T6	Random	68.80	601	●	●	●
RSS190.5	190.5	6061 T6	Random	77.24		●	●	●
RSS200/RSS203.2	200/203.2	6061 T6	Random	86.70/88.62		●	●	●
RSS210	210	6061 T6	Random	95.33		●	●	●
RSS225/RSS230	225/230	6061 T6	Random	107.48/114.67			●	●
RSS235	235	6061 T6	Random	118.33		●	●	●
RSS250/RSS254	250/254	6061 T6	Random	138.98/141.5		●	●	●
RSS280	280	6061 T6	Random	166.26			●	●
RSS300	300	6061 T6	Random	190.93				●
RSS304	304.8	6061 T6	Random	197.01		●	●	●
RSS355	355.6	6061 T6	Random	268.15		●	●	●

Other sizes and variations may be available – contact your nearest branch for assistance.



# 6262 Bar



FINISH: Mill

STOCK CODE	DESCRIPTION D	ALLOY TEMPER	LENGTH METRE	WEIGHT KG/M	ANOD PER	STATE		
						V	N	Q
RSM16	16	6262 T91	3.6	0.57	100		●	
RSM20	20	6262 T91	3.6	0.89	100		●	
RSM25.4	25.4	6262 T91	3.6	1.376	100		●	
RSM35	35	6262 T91	3.6	2.607	114		●	
RSM39	39	6262 T91	3.6	3.37	122		●	
RSM40	40	6262 T91	3.6	3.394	125		●	
RSM45	45	6262 T91	3.6	4.35	140		●	
RSM50	50	6262 T91	3.6	5.54	159		●	
RSM60	60	6262 T91	3.6	7.98	189		●	
RSM65	65	6262 T91	3.6	9.36	204		●	
RSM70	70	6262 T91	3.6	10.85	220		●	
RSM75	75	6262 T91	3.6	12.46	236		●	
RSM90	90	6262 T91	3	18.044	283		●	

Other sizes and variations may be available – contact your nearest branch for assistance.

